

Tel-Tru Sanitary Pressure Gauge MODEL 81

CHEM LINE

For the most harsh, heavy duty, and caustic applications, the Model 81 sanitary pressure gauges have a unique Teflon® coated 316L stainless steel diaphragm, tempered glass window, and pulsation dampening system. They are waterproof for submersion cleaning or CIP.

Model 81



► SPECIFICATIONS:

Dial size/Accuracy:	2½" (63mm) ±.75% FS 3½" (90mm) ±.75% FS 5" (120mm) ±.75% FS
Case:	304 SS Glycerine filled - food grade
Bezel:	304 SS
Wetted Materials:	PTFE Coated 316L SS
Internal Materials:	Brass/bronze system/movement Mechanical dampening
Transmission Fluid:	Glycerine system fill
Connection Fitting:	1½" Tri-Clamp® Lower mount or center-back mount
Lens:	Tempered glass
Pointer:	Aluminum with re-zero adjustment
Dial:	White aluminum
Ranges:	See chart: 30" Hg to 600 psi
Scale:	PSI or dual PSI/Bar
Over range protection:	P max + 30%
Sanitary Standard:	Meets 3-A Sanitary Standard 74-06 requirements.
Traceable ID:	Marked with order and date code
Environmental Protection:	Waterproof, can be CIP

► AVAILABLE OPTIONS:

- Polycarbonate window
- 2, 2½, or 3" fittings
- Dry case
- High temperature option (>250°F ≤ 500°F) Viton® Seal
- Other fitting types (including **Cherry Burrell**, **APC**, and **Bevel Seat**) and sizes are available on request.

► REPAIR SERVICE:

- Disassemble, clean, and inspect all components
- Replace/repair damaged or worn components
- Reassemble and calibrate to original factory specifications

► AVAILABLE CASE STYLES AND DIMENSIONS:

DIAL	Tri-Clamp Fitting	A	B	C	D	E	F	G
2581 2½"	1½"	2.5" (63.5mm)	3.81" (96.8mm)	1.99" (50.5mm)	1.31" (33.3mm)	.44" (11.2mm)	2.63" (66.8mm)	.56" (14.3mm)
	2"	2.5" (63.5mm)	3.81" (96.8mm)	1.99" (50.5mm)	1.31" (33.3mm)	.44" (11.2mm)	2.63" (66.8mm)	.56" (14.3mm)
3581 3½"	1½"	3.68" (93mm)	5.63" (143mm)	1.99" (50.5mm)	1.88" (48mm)	.63" (16mm)	4.06" (103mm)	.88" (22mm)
	2"	3.68" (93mm)	5.63" (143mm)	1.99" (50.5mm)	1.88" (48mm)	.63" (16mm)	4.06" (103mm)	.88" (22mm)
5081 5"	1½"	5.06" (129mm)	7" (178mm)	1.99" (50.5mm)	2.3" (59mm)	.63" (16mm)	4.5" (114mm)	.88" (22mm)
	2"	5.06" (129mm)	7" (178mm)	1.99" (50.5mm)	2.3" (59mm)	.63" (16mm)	4.5" (114mm)	.88" (22mm)

► TEMPERATURE LIMITS:

Process Temperature Range:	10°F to 250°F (-12°C to 121°C)*
Ambient Operating Limits:	25°F to 160°F (-4°C to 71°C)
Ambient Storage Limits:	0°F to 250°F (-18°C to 121°C)
*500°F (260°C) is maximum process temperature with high temperature option	

► MODEL CODES:

2581	2½" dial
3581	3½" dial
5081	5" dial

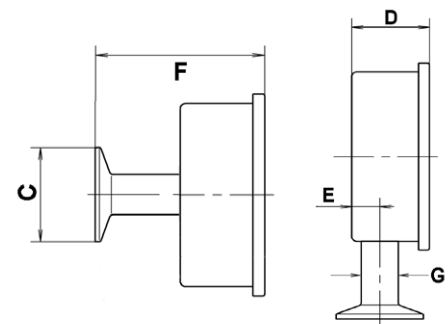
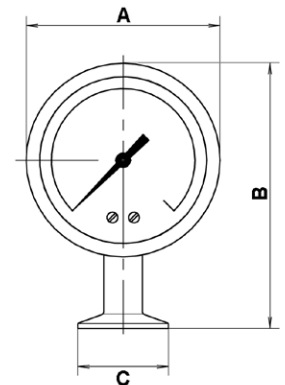

Tel-Tru Manufacturing Company

408 St. Paul St., Rochester, New York 14605 USA

Phone: 585.232.1440 • 800.232.5335 • Fax: 585.232.3857 • E-mail: info@teltru.com • Web: www.teltru.com

Tel-Tru Sanitary Pressure Gauge MODEL 81

CHEM LINE

How to Order

Ordering Example: Chem Line, 3½" dial, PTFE Coated 316L SS wetted parts, 304 SS case, 2" connection size, Lower back location, Tri-Clamp connection type, 0-160 psi & 0-11 bar range, Glycerine filled case.

A B C D E F G H I
3 5 8 1 8 S 9 L A E 4 F * G

Key: X = Available S = Standard

Code	Description	Available		
A	Model			
	2581 Chem Line, 2½" dial	2581	3581	5081
	3580 Chem Line, 3½" dial			
	5080 Chem Line, 5" dial			
B	Materials - Wetted Parts			
	8 PTFE Coated 316L SS	S	S	S
C	Case			
	S 304 SS	S	S	S
D	Connection Size			
	8 1½"	X	X	X
	9 2"	X	X	X
E	Connection Location			
	C Center Back	X	X	X
	L Lower	X	X	X
	V Right Side	X	X	X
	W Left Side	X	X	X
	T Top	X	X	X
F	Connection Type			
	A Tri-Clamp	S	S	S
G	Range and Scale			
	XXX See Range Chart			
H	Options* Insert codes only if required			
	P Polycarbonate Lens	X	X	X
	D Drag Pointer		X	X
	O Extra Dampening	X	X	X
	I High Temperature Option Process temp. >250°F	X	X	X
I	Case Fill			
	G Glycerine Filled	S	S	S
	T Dry Case	X	X	X

Ranges

	CODE
0-30 psi	C6A
0-60 psi	D6A
0-100 psi	D9A
0-160 psi	E4A
0-200 psi	E5A
0-300 psi	E8A
0-400 psi	F2A
0-600 psi	F4A
0-1000 psi	F8A
30-0-30 psi	Z2A
30-0-60 psi	Z3A
30-0-100 psi	Z4A
30-0-150 psi	U6A
30-0-200 psi	Z6A
30-0-300 psi	Z7A
0-30 psi & 0-2 bar	C6F
0-60 psi & 0-4 bar	D6F
0-100 psi & 0-7 bar	D9F
0-160 psi & 0-11 bar	E4F
0-200 psi & 0-14 bar	E5F
0-300 psi & 0-20 bar	E8F
0-400 psi & 0-28 bar	F2F
0-600 psi & 0-40 bar	F4F
0-1000 psi & 0-70 bar	F8F
30-0-30 psi & 1-0-2 bar	Z2Z
30-0-60 psi & 1-0-4 bar	Z3Z
30-0-100 psi & 1-0-7 bar	Z4Z
30-0-150 psi & 1-0-10 bar	U6Z
30-0-200 psi & 1-0-15 bar	Z6Z
30-0-300 psi & 1-0-20 bar	Z7Z

Other ranges are available, including PSI/Kg/cm² and PSI/KPa.

Repair Service

(order separately)

RSPG81-35 3½" Chem Line pressure gauges
RSPG81-50 5" Chem Line pressure gauges

Certificates

(order separately)

10000016 Material Certificate
10000002 Calibration Certificate

* See Ordering Example, top of page.
 Other fitting types and sizes are available on request.
 Other case fill materials and transmission fluids are available on request.

Shipping weight approximately 3lbs. (1.3kg)

Teflon® is a registered trademark of E. I. du Pont de Nemours and Company or its affiliates.

Tri-Clamp® is a registered trademark of Tri-Clover, Inc.

Viton is a registered trademark of DuPont Performance Elastomers.

Product specifications and pricing are subject to change without notice.



Tel-Tru Manufacturing Company

408 St. Paul St., Rochester, New York 14605 USA
 Phone: 585.232.1440 • 800.232.5335 • Fax: 585.232.3857
 E-mail: info@teltru.com • Web: www.teltru.com

SPG8108B

© 2016