

SERVICE KIT INSTALLATION

Model 30 Service Kit

NOTE: PRODUCT IMPROVEMENT CHANGES HAVE BEEN INCORPORATED IN THE REGULATOR. AS A RESULT, KIT PARTS MAY NOT LOOK EXACTLY LIKE THE PARTS WHICH THEY WILL REPLACE. IN ORDER FOR THE REGULATOR TO PERFORM PROPERLY, ALL PARTS IN THE KIT MUST BE UTILIZED.

1. Check parts in the EB-16116 service kit against the parts marked with an asterisk in the exploded view and the associated table.
2. Mark bonnet (2) and body (10) so they can be reassembled properly. Remove four screws (3) holding bonnet (2) to body (10).
3. Set aside bonnet (2), range spring washer (4) and range spring (5).
4. Remove diaphragm assembly (6) and discard.
5. Remove four screws (7) holding seal plate (8) to body (10).
6. Remove two screws (16) holding retainer plate (14) and cup (15) to body (10).
7. Remove retainer plate (14), cup (15), inner valve assembly (13) and screen (12).
8. Remove seal plate assembly (8) from body (10) and discard.

NOTE: It will be necessary to lift and twist the plate in order to remove it. Make sure that the aspirator is not damaged in the process of removal.

9. Remove seal plate gasket (9) from body (10) and discard.
10. Using a suitable dowel rod, tap out the seat ring assembly (11) from body (10) and discard.
11. Secure seat ring assembly (11) from service kit and drop into bottom hole in the body (10), brass end first. Insure that it is seated against the shoulder in body (10).

12. Secure seal plate gasket (9) from service kit and place in body (10), narrow end of hole over the port in the body (10) marked with an arrow going out of body.
13. Using four screws (7) secure new seal plate (8) to body (10) with aspirator extending into port identified in step 12.
14. Place filter screen (12) from service kit in the groove in inner valve assembly (13) from service kit. Insert the assembly into the hole in the bottom of the body (10), aligning pintle of the inner valve assembly (13) so that it drops in to seal plate (8) center tube.
15. Tap inner valve assembly (13) so that the brass shoulder is flush with the bottom of the body (10). Place retainer plate (14) over the inner valve assembly (13) aligning it with holes in the body (10).
16. Place retainer cap (15) over the retainer plate (14) and secure to body (10) with two screws (16).
17. Secure diaphragm assembly (6) from service kit and place on body (10) so that the oval cup faces up and the four holes in the diaphragm assembly (6) are aligned with holes in the body (10). See Note A.

CAUTION: Make sure that the hole in the center of diaphragm assembly (6) is directly over the inner valve assembly (13) pintle.

18. Set range spring (5) over the nut on top of diaphragm assembly (6) and set spring cup (4) on top of the range spring (5), range screw recess facing up. Place some Molykote grease in the recess.
19. Place bonnet (2), over body (10) making sure that marks from step 3 are aligned.
20. Using four screws (3), secure bonnet (2) to body (10).
21. Reinstall the regulator in accord with installation instructions in the IOM and follow instructions in the operators section for placing the regulator back in service.

Index	Part No.	Description
2	EB-9456	Bonnet
3	EB-1032-12	Screw
4	EB-7145	Spring Seat
5	EB7141-()	Spring
*6	EB-15838-1	Control Diaphragm Assy
*6 A	EB-16122-1	Gasket
7	EB-1032-5	Screw
8	EB-15884-1-	Seal Plate Assembly
*9	EB-15844-1	Gasket
10	EB-15614-1	Body
*11	EB-6088-1	Seat
*12	EB-6017	Screen
*13	EB-1820	Inner Valve Assembly
14	EB-6027	Retainer Plate
15	EB-7136	Retainer Cap
16	EB-1032-6	Screw
*EB-16116- Service Kit Components		

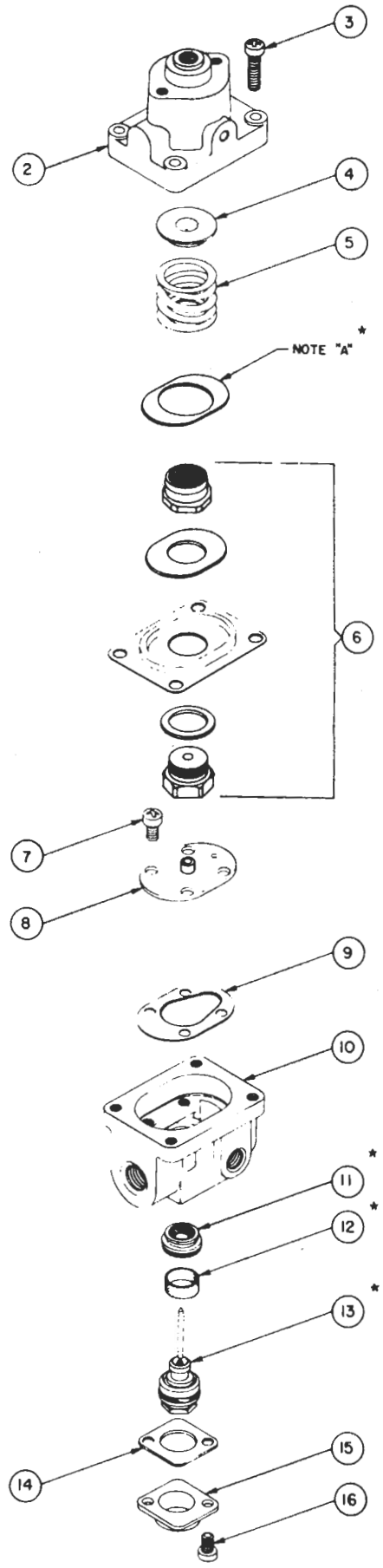

NOTE A:
 GASKET TO BE APPLIED (IF REQ'D) TO PISTON AT
 TOP OF DIAPHRAGM ASSEMBLY. USE ONLY WITH
 MODEL 30 UNITS HAVING OLD STYLE BONNETS.