

FOR "T" GROOVE CYLINDERS

series	Ø (mm)	code fastening kit
441	32 ... 100	(1)
449	32 ... 100	(1)
453	32 ... 100	(1)
454	32 ... 100	no groove

(1) Fastening mini-kit (special nut + screw) supplied **with** detectors

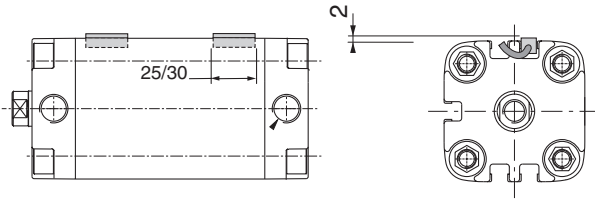

NOTE:

Series 441 cylinders Ø 32-100 mm : 6 "T" grooves

Series 449 cylinders Ø 20-25 mm : 4 "T" grooves
Ø 32-100 mm : 5 "T" grooves

Series 453 cylinders Ø 32-100 mm : 5 "T" grooves

Series 454 cylinders Special adaptor for magnetic detector (code: **P494A0029100A00**)



In order to control **the max. end** of cylinder stroke, the detectors must be mounted in the following direction:

Series 441-449-453-454 cylinders:

Ø32-40: cable oriented towards the middle of the cylinder
Ø50-100: any position

FOR TIE RODS CYLINDERS

series	Ø (mm)	code fastening kit
		lead outlet version
450	32-40	P494A3129200A00
	50-63-80	P494A5129200A00
	100	P494A8129200A00
	125-160-200	P494AP129200A00



Ø cylinder	32	40	50	63	80	100	125	160	200
D	30	33	38	44	50	69	77	89	104
E	26	30	35	39	49	61	69	87	101

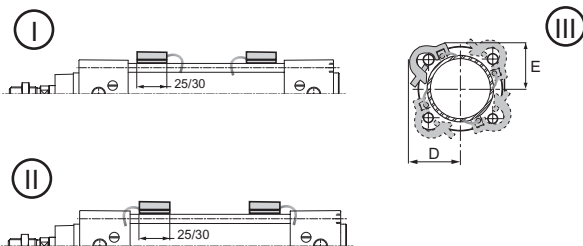

- I It is possible to fasten the detector with its electric outlet to the centre of the cylinder (in order to be able to control the **max. end** of travel of the cylinder)
- II In order to fasten the detector with its electric outlet to the rear, rotate **the unit** detector + collar by 180°
- III The detectors can be mounted on any one of the 4 **tie rods**.



FOR ROUND CYLINDERS

series	Ø (mm)	code fastening kit	
		plastic	stainless steel (AISI 303 + 304)
435 438	8-10	-	P494AG129600A00
	12	P494AJ129300A00	P494AK129600A00
	16	P494AK129300A00	P494AK129600A00
	20	P494AL129300A00	P494AL129600A00
	25	P494AM129300A00	P494AL129600A00
	32	P494A3129300A00	P494A3129600A00
	40	P494A4129300A00	P494A4129600A00
	50	-	P494A5129600A00
	63	-	P494A6129600A00

Ø 12 to 40 mm

Ø 8 to 80 mm

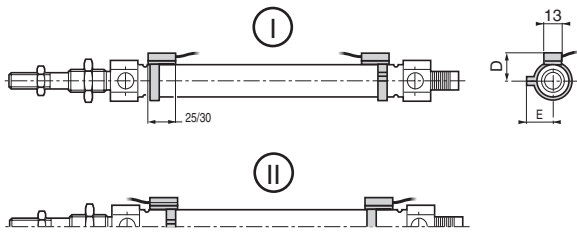

It is possible to mount magnetic detectors for **intermediate** position indication : mounting by collar

Ø 8-20 : any position.

Ø 25-80 : cable oriented towards the cylinder ends

Ø cylinder	8	10	12	16	20	25	32	40	50	63
D	14,5	15,5	15	16,5	19	21,5	26,5	31	38	45
E	13,5	14,5	16,5	19	20,5	23	29,5	31,5	36,5	43,5

ⓘ On all diameters, it is possible to mount the detector with its electrical outlet facing towards the cylinder barrel (in order to be able to control the **max. end** of travel of the cylinder).

Ⓜ In order to fasten the detector on cylinder diameters 25 to 63 with its electrical outlet facing towards the cylinder ends, rotate the detector + collar **unit** by 180°.